



MAHSA
UNIVERSITY

MEDICAL IMAGING IMMERSION CAMP 2019

*Inclusive of 2 Days
Conference Pass*



MAHSA University

MAHSA University is one of Malaysia's largest private medical and health university and was established in 2005. The University is located on a 48-acre land, just minutes from the Kuala Lumpur International Airport.

Characterised by a tradition of innovation, MAHSA constantly improves the quality of education and student experience, and strengthens the quality and impact of its research, to be well on its way towards its vision of becoming the Centre of Excellence in higher education in the region. Indeed, the various accreditations by Regulatory Boards, Professional Bodies and International Accreditation Standards further affirms the highest quality at MAHSA.

Today MAHSA University has students from 75 different countries and not just from the region of Asia, but as far as Australia, United Kingdom, Canada and the United States of America.

Benefits

Enhanced Employability

Employers value students who are flexible, adaptive and equipped with cross-cultural skills. Students who have participated in mobility programs are often deemed to be more matured.

Soft Skills

Mobility programs often increase students' interpersonal skills, communication skills as well as adaptation skills.

Life Experience

Experiences and outdoor learning are two significant features of the mobility program. Studying, learning and living abroad exposes students to other cultures in a priceless way.

Building Network

Mobility programs can open doors of opportunity for students in the global arena. Students build international connections and rapport through networking with students and potential employers through different mobility program.

MAHSA's Mobility Programs



Learn!



14 days!



**Celebrate
Friendships!**



**Discover
Something
New!**

Expand your horizons and join MAHSA's Mobility Programme as part of your educational experience. Discover new cultures, make new friends from all over the world and gain a competitive edge by being a global citizen.

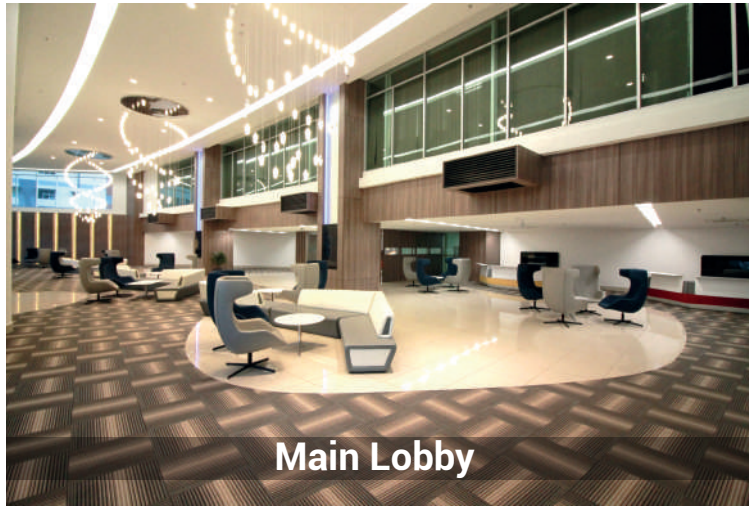

Main Lobby



Auditorium

STUDENT - CENTERED F A C I L I T I E S



Library

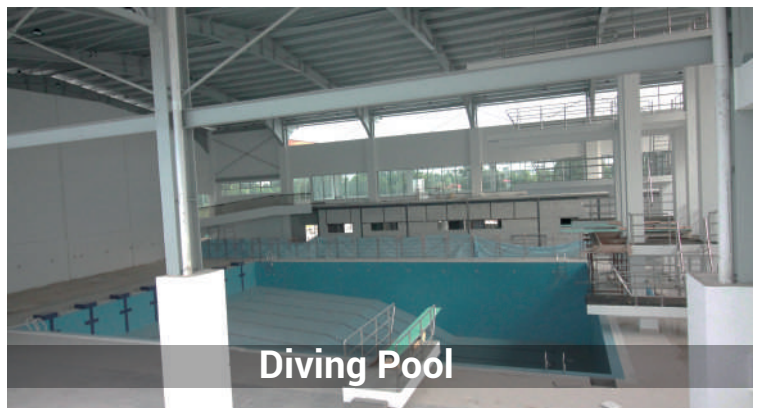

Diving Pool



Science Labs



Football Field

PROGRAMME AGENDA

| | CONTENT | |
|--------|---|-----------------------------|
| DAY | AM | PM |
| DAY 1 | Arrival at Kuala Lumpur International Airport Check in accommodation and mingle with MAHSA student ambassadors | |
| DAY 2 | Welcoming remarks at Medical Imaging Dept. Exploring | Briefing on workshop |
| DAY 3 | Class – Digital Imaging | Student Activity |
| DAY 4 | Class – Image Evaluation in Digital Imaging | Hands on – Image Evaluation |
| DAY 5 | Educational Visit to Malaysia Nuclear Agency | |
| DAY 6 | KL City Tour | |
| DAY 7 | Free and Easy | |
| DAY 8 | Class – Trauma Imaging | Case Study Presentation |
| DAY 9 | Conference – Day1 | |
| DAY 10 | Conference – Day2 | |
| DAY 11 | Hospital Visit | |
| DAY 12 | Explore Traditional Games | Reflection & Farewell Party |
| DAY 13 | Free and Easy | |
| DAY 14 | Airport Transfer | |



ACCOMMODATION

Twin Sharing with aircondition - USD 460
Quad Sharing with fan - USD 320

Including:

- Airport pick up and send - off
- Accommodation
- 2 Days Conference Pass
- Training documents and relevant handouts
- Commuting fee
- Welcome & Farewell party

Excluding:

- Visa fee
- Two-way airfares
- Personal expenses
(phone call, laundry, postage & etc.)
- Meals

VISA

MAHSA University supports relevant documents for student to obtain a VISA at the Embassy or Consulate General in their home country. Students will bear VISA application cost.

INFORMATION

FACILITIES & SERVICES



24-Hour
Security with
CCTV



Free Wifi
Access



Launderette



24-Hour Warden
on Standby



Vending
Machines



Access Card
System

HOW TO APPLY

Applicants to apply via the following online application form:

<https://forms.gle/ZXjU83Q5YWcmRdaWA>



For more information, please write to us:

Email: studentexp@mahsa.edu.my

MAHSA UNIVERSITY

Jalan SP2, Bandar Saujana Putra, 42610 Jenjarom, Selangor, Malaysia

Contact us: +603-5102 2200 | 1800 88 0300 | studentexp@mahsa.edu.my | www.mahsa.edu.my



MAHSA University